

All on magnetic
equipment



all **MAG** Division



TECNOMAGNETE®

Index

Hand controlled magnetic lifters

MaxX lifters	p. 3
MVS series	p. 3

Permanent-electro battery lifters

Bat-Grip 300	p. 4
--------------	------

Permanent-electro magnetic chucks

KIT MDS 304 for Spark erosion	p. 4
KIT SQ 304 HD50 for milling	p. 5

Permanent magnetic chucks

PL/M MICROFINE pole pitch (1 + 0,5 mm)	p. 6
PL/F FINE pole pitch (3 + 1 mm)	p. 6
PL/FC round FINE pole pitch (3 + 1 mm)	p. 6
PL/RA RADIAL pole	p. 7

Sinus tables

TS/S* –single opening	p. 7
TS/D* –double opening	p. 7

Magnetic prisms

MV-7	p. 8
MV-12	p. 8
MV-10	p. 8
MV-15	p. 8

Laminar blocks

LB1	p. 8
LB2	p. 8
LB3	p. 8

Dial gauge magnetic stands

MB60 /M1	p. 9
MB60 /S2	p. 9
MB60 /M2	p. 9
MB60 /M3	p. 9
MB60 /SH	p. 9
MB60 /SF	p. 9
MB30 /M1	p. 9
MB60 /FC	p. 9

Permanent magnets

AK – Pocket	p. 10
AH – Heavy	p. 10
AB – Button	p. 10
AP – Pot	p. 10
AS – Shallow pot	p. 10
AC – Round bar	p. 11
AR – Rectangular bar	p. 11
NC – Neodimium pot	p. 11
FC – Ferrite shallow pot	p. 11
MT – Magnetic tape	p. 11

Magnetic squares

MS1	p. 12
MS2	p. 12
MS3	p. 12
MS4	p. 12
MS4-A	p. 12
MS5	p. 12
MS6	p. 12

Magnetic holder

GM-A	p. 12
------	-------

Magnetic flouters

MF1	p. 13
MF2	p. 13
MF3	p. 13
MF4	p. 13
MF5	p. 13

Drilling machine with magnetic base

TD50	p. 13
------	-------

Demagnetisers

DM/P Bench demagnetiser	p. 14
DM/T Tunnel - rectangular	p. 14
DM/C Tunnel – circular	p. 14

Magnetic separators

MH	p. 14
----	-------

Permanent magnets for industrial application

AlNiCo	p. 15
Ferrite	p. 15
Rare earth	p. 15

Digital gaussmeter

DG5060	p. 15
--------	-------

www.allmag.net





A range of 5 models available with lifting capacity from 250 kg up to 2000 kg, safety factor 3.

- Monoblock construction.
- Nickel coated.
- Maintenance free.
- Light weight, compact, powerful, reliable.
- Ideal for flat and round loads, finished or rough.

Practical and easy-to-use for all the requirements of the modern mechanical industry.



MVS

Vertical loading system for flat components available for MaxX 250/500/1000.

Model	Dimensions (mm)			Weight (kg)	Load plate Max (kg)	Load round Thickness min. (mm)	Load round Max (kg)	Load round Diam. Max. (mm)	Force (kg)
	Length	Width	Height						
MaxX 250	189	185	79	6	250	20	100	300	750
MaxX 500	249	235	101	15	500	25	200	400	1500
MaxX1000	342	316	131	34	1000	40	400	450	3000
MaxX1500	383	457	171	66	1500	45	600	500	4500
MaxX2000	457	457	171	80	2000	55	800	600	6000



The Mag and Demag cycles performed with radio control allow to a single operator to handle loads of any dimension and shape, without main power supply also in rather accessible areas.

The load, held exclusively by permanent magnets power, doesn't need any power supply during handling operation.



Model	Dimensions (mm)			Weight (kg)	Load plate Max (kg)	Thickness min.(mm)	Load round Max (kg)	Diam. Max.(mm)	Force kg
	Lenght	Width	Height						
Bat-Grip 300	690	328	400	160	3000	25	700	200	6000

Kit **MDS** Permanent electro magnetic chuck for EDM "spark erosion"



The permanent-electro magnetic chuck for EDM with electronic control unit is unaffected by main power breakdown, no electric energy is needed during machining operations. No overheat. Uniform clamping.

Remote control with power regulation.
Total demagnetization even with alloyed material.
Monobloc construction associated with washing channels circuit.
Perfect fluid proofing.
High reliability.



Model SQ	Technical characteristics		
	Dimensions (mm)	Weight (kg)	Thickness (mm)
MDS 304	300x450	52	54

INCLUDED



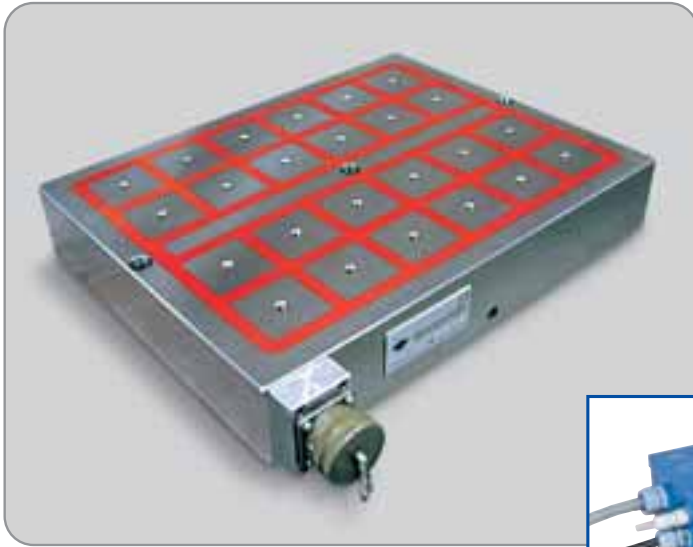

Power and safety are the main characteristics of the innovative and patented Quadsystem permanent electro technology in use on permanent electro magnetic chuck with control unit. Best solution on milling machines and machining centre.

- Quick, versatile and uniform clamping
- 5 faces free for full machining in a single set up
- No vibrations during machining operations
- Reduced tools consumption
- High stock removal
- Better finishing and great accuracies



- Easy installation on the machine
- Practical use
- Convenient and cost effective

Monobloc construction. Great strength, long term reliability and maintenance free.

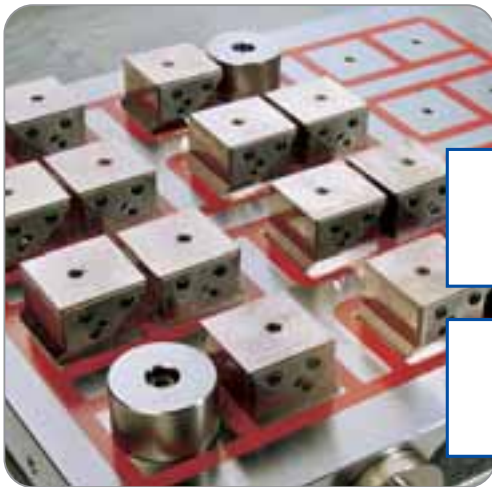

AUTOMATIC SHIMMING SYSTEM - INCLUDED -

Composed of fixed pole extensions series (n.3 PFR 50/32) and mobile (n.13 PMQ 50/32), capable of adjusting itself to the workpiece to be clamped and to lock it firmly with no deformation.

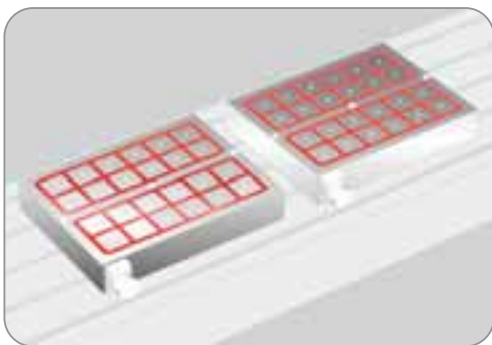
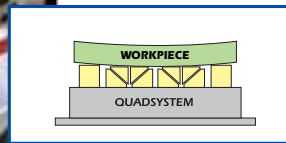
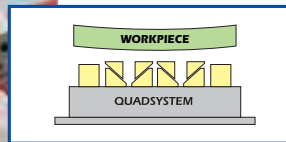

Tables



Vertical application



Model	Technical characteristics				
	Dimensions (mm)	Weight (kg)	Poles n.	Thickness (mm)	Force Tons.
SQ 304 HD50	320x412	70	24	68	8,5

Brass and steel surface for maximum resistance and accuracy. Removable hexagonal key. Side stops. Permanent magnet circuit with high efficiency lifetime. Coolant and waterproof construction.

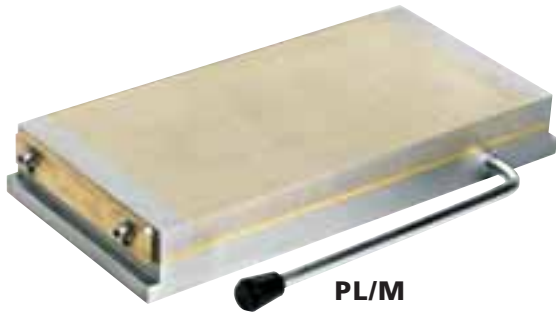

PL/M

Best for grinding operations on small and thin components.

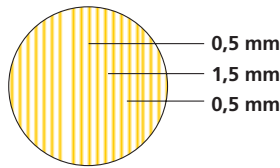
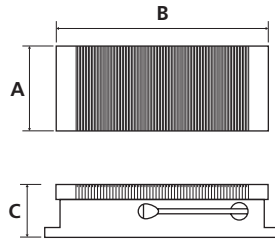

Micro pole serie

Model PL / M	Dimensions (mm)			Weight ~ kg
	A	B	C	
PL/M 1018	105	180	45	7
PL/M 1220	120	200	45	9
PL/M 1325	130	250	45	12
PL/M 1530	150	300	45	18
PL/M 1535	150	350	45	20
PL/M 1540	150	400	45	23
PL/M 1545	150	450	45	26
PL/M 2030	200	300	45	23
PL/M 2040	200	400	45	31
PL/M 2045	200	450	45	35
PL/M 2050	200	500	50	40
PL/M 2063	200	630	52	53
PL/M 2540	250	400	50	42
PL/M 2563	250	630	52	68

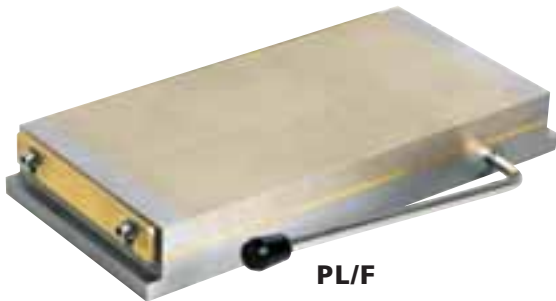

PL/F

Highest clamping force on small-medium components.

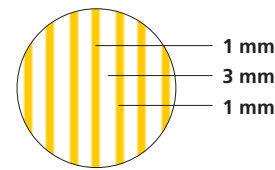
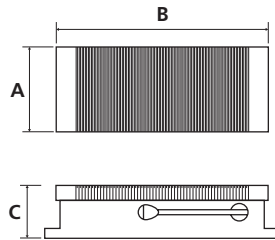

Fine pole serie

Model PL / F	Dimensions (mm)			Weight ~ kg
	A	B	C	
PL/F 1220	120	200	45	9
PL/F 1325	130	250	45	12
PL/F 1530	150	300	45	17
PL/F 1535	150	350	45	20
PL/F 1540	150	400	45	23
PL/F 1545	150	450	45	26
PL/F 2030	200	300	45	23
PL/F 2035	200	350	45	27
PL/F 2040	200	400	45	31
PL/F 2045	200	450	45	35
PL/F 2050	200	500	50	40
PL/F 2063	200	630	52	53
PL/F 2540	250	400	50	42
PL/F 2563	250	630	52	68



PL/FC

Best for grinding operations on thin rings also with irregular shape.

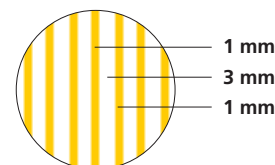
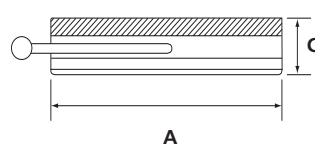

Circular/Fine pole serie

Model PL / FC	Dimensions (mm)		Weight ~ kg
	A	C	
PL/FC 130	130	50	9
PL/FC 160	160	50	12
PL/FC 200	200	50	17
PL/FC 250	250	50	20
PL/FC 300	300	50	23
PL/FC 400	400	52	26

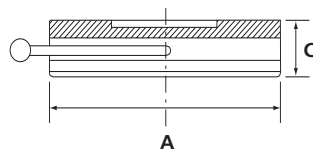

Best for turning operations on thin rings also with irregular shape.

Radial pole serie

Model	Dimensions (mm)		Weight ~ kg
	A	C	
PL/RA 150	150	50	9
PL/RA 200	200	50	12
PL/RA 250	250	50	17
PL/RA 300	300	52	20

Single and double opening sine tables

Sine table is a useful tool for tilt work pieces.

The tilting range is from 0° to 45° by sine car mechanical conception.

The equipment provided of a trigonometric table showing minutes and degrees.

It allows to reach the wished angle of inclination with DIN 875 ($\pm 0,005 + L/50000$, about ± 20 seconds) tolerance.

Available with PL/M chuck fitted on.

SINGLE OPENING SINE TABLE

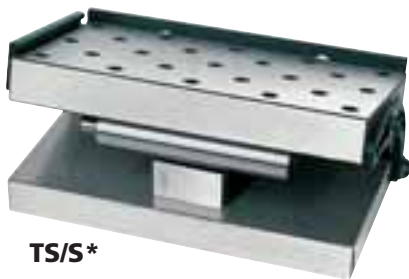

TS/S*

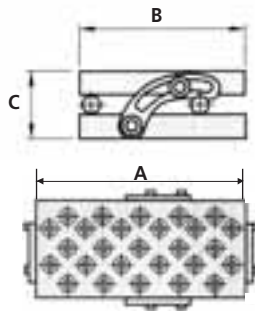

Model	Dimensions (mm)			Weight ~ kg	Mod.PL/M combined
	A	B	C		
TS/S1	175	100	60	8	1018
TS/S2	300	150	60	18	1530

DOUBLE OPENING SINE TABLE



TS/D*

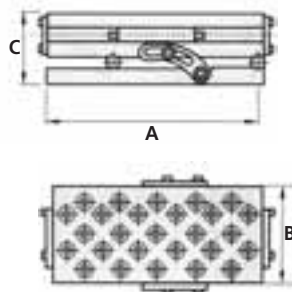

Model	Dimensions (mm)			Weight ~ kg	Mod.PL/M combined
	A	B	C		
TS/D1	175	100	100	12	1018
TS/D2	300	150	100	31	1530

With grinded surfaces at "V" groove,
best to clamp round or rectangular pieces, in grinding or marking-out operations.



MV-7

Magnetic "V" prism switch activated.
Standard version for flat and round pieces.

	MV-7
Lenght (mm)	70
Width (mm)	60
Height (mm)	72
Angle a V	90'
Peso (kg)	1,5
Clamping force on flat (kg)	25



MV-12

Magnetic "V" prism switch activated.
Best for flat and round pieces.
Strengthened version.

	MV-12
Lenght (mm)	102
Width (mm)	70
Height (mm)	95
Angle a V	90'
Peso (kg)	3,6
Clamping force on flat (kg)	40



MV-10 / MV-15

Magnetic "V" prism switch activated.
Best for flat and round pieces.
Strengthened version.

	MV-10	MV-15
Lenght (mm)	100	150
Width (mm)	100	150
Height (mm)	100	150
Poles (mm)	5-11	6-18
Weight (kg)	7,5	22
Clamping force on flat (kg)	50	140
Clamping force on "V" (kg)	25	50

LB

Laminar blocks



LB1

Useful to transfer magnetic fluid
from chuck surface to the work-piece.

Pole pitch 3,5 mm (brass) – 5 mm (steel).

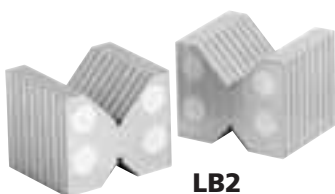

LB2



LB3

	LB1	LB2	LB3
Lenght (mm)	50	100	110
Width (mm)	60	50	60
Height (mm)	48	25	48
Poles (mm)	3,5/5	3,5/5	3,5/5
Weight (kg)	1,2	1,2	1,3



Dial gauge stand with chromium plated rods. Magnetic base with ground surfaces grinded, and "V" groove.

M1 - M2 - M3 Series, provided of Micrometric adjusting system.

Model	Dimensions (mm)		
	Vertical rod	Horizontal rod	Hole
MB60 /M1	Ø 12 x 176	Ø 10 x 150	Ø 8
MB60 /M2	Ø 16 x 225	Ø 12 x 120	Ø 8
MB60 /M3	Ø 16 x 230	Ø 16 x 203	Ø 8
MB30 /M1	Ø 12 x 176	Ø 10 x 150	Ø 8

S2 Series, provided of standard regulation.

Model	Dimensions (mm)		
	Vertical rod	Horizontal rod	Hole
MB60 /S2	Ø 16 x 225	Ø 12 x 180	Ø 8

SF Series, provided with flexible chromium plated rod.

Model	Dimensions (mm)		
	Flexible rod	Max extension	Hole
MB60 /SF	Ø 16	355	Ø 8

SH Series, provided with light alloyed rods with hydraulic fixturing system, complete of micrometric adjusting system.

Model	Dimensions (mm)		
	Rod	Arm	Hole
MB60 /SH	110	102	Ø 8

Fluid conveyor FC series, with flexible feeding pipe in high resistance plastic material, complete of round and flat nozzle. Magnetic base MB/60.

Model	Dimensions		Ø pipe
	Work angle		
MB60 /FC	150°		1/4"

Magnetic bases

Mod.	Dimensions (mm)				Magnetic force
	Lenght	Width	Height	Weight (kg)	
MB/60	63	50	55	1	60 kg (588 N)
MB/30	48	44	51	0,5	30 kg (294 N)

The magnetic field is activated by a switch or by a push-button on the base.

Permanent magnets in alnico alloy.

Permanent magnets shielded with a brass ring.

The shield grants higher magnetic coactivity, allowing the item to maintain its characteristics even when inserted in ferrous components. The outer protection provides resistance to impact.

ALNICO ALLOY MAGNETS



POCKET

Horseshoe converging pole magnets.

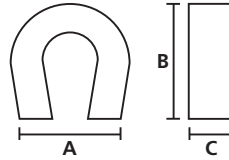

Model PM	Dimensions (mm)			Force (kg)
	A	B	C	
AK 79	22,2	25,4	7,9	2,4
AK 159	27	35	15,9	4



HEAVY

Heavy duty bi-pole magnets with threaded hole.

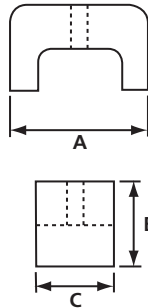

Model PM	Dimensions (mm)				Force (kg)
	A	B	C	Hole	
AH 20	30	20	20	4	4,5
AH 25	40	25	25	5	9
AH 30	45	30	30	5	12
AH 405	57	35	40,5	2x7,9	23,5
AH 572	70	41,3	57,2	2x7,9	37
AH 826	79,4	54	82,6	2x9,5	47
AH 62	60	40	62	6,5	35
AH 86	79	54	86	-	60

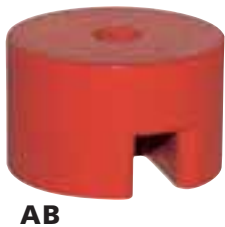

BUTTON

Button magnets with threaded hole.

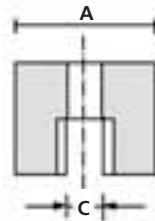

Model PM	Dimensions (mm)			Force (kg)
	A	C	Hole	
AB 125	12,5	9,5	4,5	0,7
AB 191	19,1	12,7	4,8	1,9
AB 254	25,4	15,9	4,8	3,4
AB 318	31,8	25,4	7,1	4,8
AB 222	22,2	19,1	4,8	3



POT

Cylindrical magnets with threaded hole.

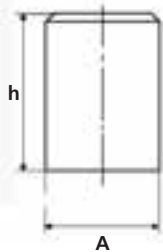

Model PM	Dimensions (mm)			Force (kg)
	A	h	Hole	
AP 95	9,5	15,1	M3	1
AP 127	12,7	15,9	M4	2
AP 175	17,5	16	M6	2,7
AP 205	20,5	19	M6	4
AP 27	27	25	M6	6
AP 35	35	30	M6	14,5



SHALLOW POT

Button magnets with threaded hole.

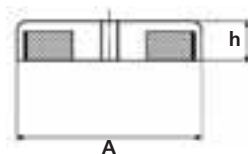

Model PM	Dimensions (mm)			Force (kg)
	A	h	Hole	
AS 191	19,1	7,75	3,7	3
AS 286	28,6	8,7	4,8	5
AS 381	38,1	10,6	4,8	13



BAR
Cylindrical bar magnets in alnico alloy.

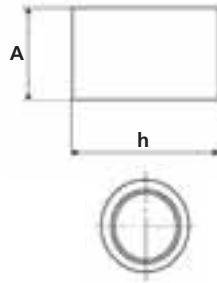

Model PM	Dimensions (mm)	
	A	h
AC 10	4	10
AC 20	5	20
AC 25	8	24
AC 30	10	30

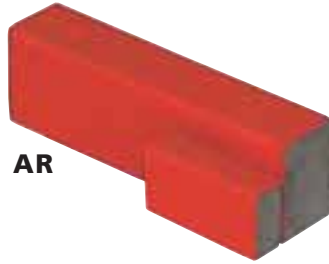

BAR
Rectangular bar magnets in alnico alloy.

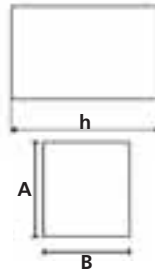

Model PM	Dimensions (mm)		
	A	B	h
AR 50	15	10	50
AR 75	15	10	75
AR 20	10	5	20
AR 40	12,5	5	40
AR 60	12,5	5	60
AR 65	15	5	60

NEODIMIUM MAGNETS



POT
Bipolar magnets with high power and small dimensions.

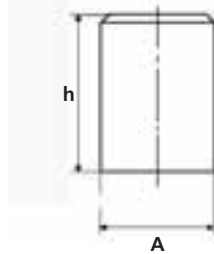

Model PM	Dimensions (mm)			Force (kg)
	A	h	Hole	
NC 127	12,7	11,6	M5x5	2
NC 16	16	15,6	M6x5	5
RC 22	22	20	M6x6	9
RC 25	25	25	M6x6	15

FERRITE MAGNETS



SHALLOW POT
Permanent magnets supplied with hook clamping.

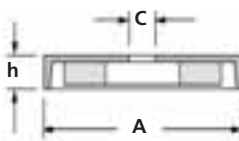

Model PM	Dimensions (mm)			Force (kg)
	A	h	C	
FC 50	50	11,1	8,5	11
FC 80	80	20,5	10	50
FC 100	100	20,5	10	70

MAGNETIC TAPE



TAPE
Plastic-ferrite magnetic tape, suitable for wide range of use and for painted surfaces.

Model PM	Dimensions (mm)		
	Width	Lenght	Thickness
MT 10	10	1000	3
MT 20	20	1000	3
MT 40	40	1000	3
MT 600	600	800	3

For the corner positioning of ferrous round and flat pieces; ideal for welding and tracing operations.



MS-1



MS-2



MS-3



MS-4



MS-4A



MS-5



MS-6

Dimensions (mm)

Model	Length	Width	Height	Angle	Round min.	Weight (kg)
MS-1	110	110	t16	-	13	0,6
MS-2	85	50	t13	-	10	0,3
MS-3	95	110	t16	-	13	0,5
MS-4	140	37	140	90°	-	1,7
MS-4A	105	36	105	75°/60°/45°	-	1,5
MS-5	225	20	225	90°	-	2
MS-6	300	35	300	90°	-	4,6



GM-A

Gripping magnet
Best for manual thin sheet handling.

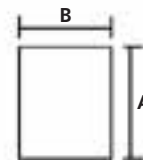
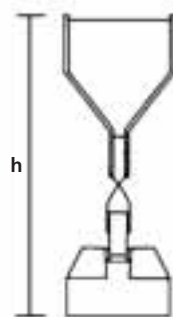

Model	Load Max (kg)	Dimensions (mm)			Weight (kg)
		A	B	h	
GM-A	50	120	100	270	3

Located on board of the steel sheet stack, the floaters induce magnetic flux into the sheets, rejecting each other. It becomes easy to quickly remove the upper sheet.

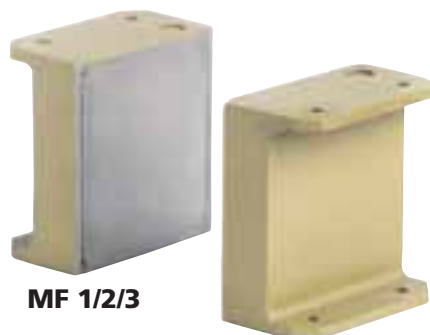

MF 1/2/3



MF 4/5

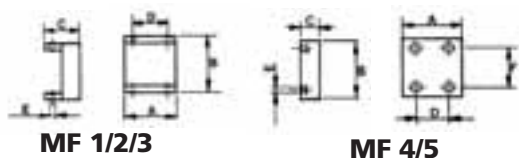

MF 1/2/3

MF 4/5

Model	Dimensions (mm)						Weight (kg)	Thick. max	Stack
	a	b	c	d	e	f			
MF1	96	102	52	60	7		1,3	6	80
MF2	132	122	52	90	9		2,1	6	100
MF3	132	170	60	90	9		3,6	6	150
MF4	132	356	32	90	10	250	7,5	-	320
MF5	260	350	50	150	12	250	22	-	320

Drilling machines with magnetic base

TD 50 – Portable drilling machine with magnetic base.

The electromagnetic base equipped with electronic monitoring and visual signalling system protects from machine separation from steel during drilling or cutting.

Innovative frame construction increases rigidity, tool life and quality of holes.



TD 50



Technical characteristics

Power supply	1260 W, 110-240 VAC
Motor	1200W
Spindle	MT2
Magnet force	max 12000N
Magnet base dimensions	90 x 180 mm
Two speed drill motor	I: 210 rpm / II: 420 rpm
Max drilling capacity	19 mm
Max milling capacity	50 mm
Arbor holder	19,05 mm
Max depth of cut	50 mm
Max height	524 mm
Min. height	433 mm
Length	300 mm
Width	265 mm
Weight	17 kg

AS OPTION

DU 16



Universal adapter for twist drill, MT2 tip, for drills up to 16mm diameter.

In few seconds it removes any eventual residual magnetism from the work-piece machined on a magnetic chuck.

BENCH DEMAGNETIZERS



The best for demagnetising small ferrous pieces.

Model	Dimensions (mm)		Consumption (W)
	Length	Width	
DM/P 1215	120	150	90
DM/P 1520	150	200	180
DM/P 1524	150	240	220
DM/P 2030	200	300	440

TUNNEL DEMAGNETIZERS – RECTANGULAR



High power equipment suitable to demagnetise medium size pieces, even in alloyed material.

Model	Light dimensions (mm)		Consumption (W)
	Height	Width	
DM/T 1020	100	200	3000
DM/T 1520	150	200	4500
DM/T 1535	150	350	5000
DM/T 2040	200	400	5500
DM/T 2060	200	600	7000
DM/T 3060	300	600	9000
DM/T 4060	400	600	12000

TUNNEL DEMAGNETIZERS – CIRCULAR

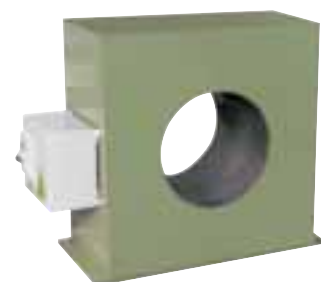

Same characteristics of the previous model, but with round light passage.

Model	Light dimensions (mm)		Consumption (W)
	Diameter		
DM/C 20	200		3500
DM/C 30	300		4500
DM/C 40	400		7000

Magnetic separators for hoppers

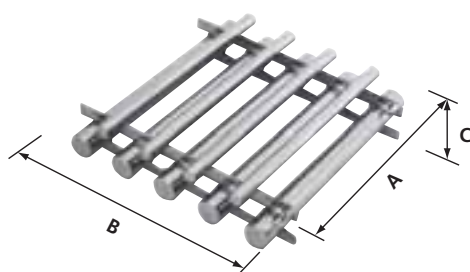

Magnetic grid in neodymium for dusts and grained materials separation. The permanent magnetic field stops ferrous magnetic elements from the others.

Model	Dimensions (mm)		
	A	B	C
MH1	200	200	50
MH2	200	250	50
MH3	300	300	50
MH4	200	200	100

Our 30 years experience is at your disposal to provide engineering assistance, selection suggestions and samples on a wide range of SINTERED ALNICO, FERRITE and RARE EARTH MAGNETS.
We can offer various sizes and shapes to meet customer specific requirements with a short delivery time.

AlNiCo



AlNiCo magnets are resistant to high temperatures and have fairly high energy products. As the name suggests, these magnets contain aluminium, nickel and cobalt. Cast Alnico can be made into shapes that may not be possible with other materials and sintered Alnico shows stronger mechanical characteristics.

Ferrite



Ferrite magnets are the most popular magnets available today and are usually composed of either barium or strontium ferrite and iron oxide. These magnets display a high level of coercive force, which allows them to be more resistant to demagnetization.

Rare Earth



Rare earth magnets are the most powerful permanent magnets available for commercial use. Generally available grades are samarium cobalt (SmCo) or neodymium iron boron (NdFeB). Rare earth materials offer energy products from 18 MGOe to over 50 MGOe, depending on material and grade.

For additional details and dedicated quotations, please provide us the following data:

Size and tolerances	<input type="text"/>	Max. temperature (C°)	<input type="text"/>
Type of magnetic material	<input type="text"/>	Quantity	<input type="text"/>
Holding power (kg)	<input type="text"/>	Application description	<input type="text"/>

Digital gaussmeter



This tool measures residual and induced magnetic fields, in a range between 0 to 20.000 gauss.
Weight 0,45 kg.

Model	Dimensions (mm)			
	Length	Width	Height	Probe thick.
DG 5060	132	135	38	2

Tecnomagnete world

The new Allmag product line comes from Tecnomagnete 30 years experience in development, manufacture and commercialization of permanent-electro magnetic systems. With tens of thousands systems all around the world in workholding on

machine tools, ferrous loads handling and quick mould change on presses, Tecnomagnete is the leader in industrial magnetism.

With Allmag Tecnomagnete world is now closer to you.



We reserve the right to make changes connected with engineering progress.

Head office:
TECNOMAGNETE spa
20020 Lainate (MI) - Italia - Via Nerviano 31
Tel. +39-02.937.591, Fax +39-02.935.708.57
e-mail: info@tecnomagnete.it



TECNOMAGNETE®
Safety Through Power

www.tecnomagnete.com

Subsidiaries:
France: TECNOMAGNETE S.A.R.L.
Germany: TECNOMAGNETE GmbH
Japan: TECNOMAGNETE Ltd
Sweden: TECNOMAGNETE AB
P.R. China: TECNOMAGNETE R.O.
USA: TECNOMAGNETE Inc.

ALLMAG-ING-2004-30/03